



3 Inch Body Pumps Features

- ★ Choice of 0.25 l/min, 0.45 l/min and 0.64 l/min 3 ratios.
- ★ High-strength alloy steel pump body, and stainless steel shell optional.
- ★ Low power consumption, and very low noise.
- ★ Standard Buna N seals for -29~120°C service, other seals available.
- ★ Output pressures up to 6000 psi (414 bar).
- ★ Pump can rotate clockwise and counterclockwise.

Description

The pump is a plunger pump, it needs to be driven by a motor and recommend using electric motor. It requires very little power, so solar energy can be used as an energy source for its motor. These pumps are used on wellhead control panel systems, Power packs on high-torque service tools. The pump application medium is hydraulic oil and it needs to be installed at a lower position than the tank. Before starting the pump, you must vent the air in the pump chamber.

Performance and Specification

Ordering Code	Rated Press. psi(bar)	Max. Intermittent Press. psi(bar)	Flow at 1500rpm	Max. Speed	Stainless Steel Shell	Inlet Port	Outlet Port
ELP-3A01N	6000(414)	6000(414)	0.24l/min	3000rpm	No	1/2"NPT	1/8"NPT
ELP-3A02N	6000(414)	6000(414)	0.45l/min	3000rpm	No	1/2"NPT	1/8"NPT
ELP-3A03N	6000(414)	6000(414)	0.64l/min	3000rpm	No	1/2"NPT	1/8"NPT
ELP-3B01N	6000(414)	6000(414)	0.24l/min	3000rpm	Yes	1/2"NPT	1/8"NPT
ELP-3B02N	6000(414)	6000(414)	0.45l/min	3000rpm	Yes	1/2"NPT	1/8"NPT
ELP-3B03N	6000(414)	6000(414)	0.64l/min	3000rpm	Yes	1/2"NPT	1/8"NPT
ELP-3A01G	6000(414)	6000(414)	0.24l/min	3000rpm	No	G1/2"	G1/8"
ELP-3A02G	6000(414)	6000(414)	0.45l/min	3000rpm	No	G1/2"	G1/8"
ELP-3A03G	6000(414)	6000(414)	0.64l/min	3000rpm	No	G1/2"	G1/8"
ELP-3B01G	6000(414)	6000(414)	0.24l/min	3000rpm	Yes	G1/2"	G1/8"
ELP-3B02G	6000(414)	6000(414)	0.45l/min	3000rpm	Yes	G1/2"	G1/8"
ELP-3B03G	6000(414)	6000(414)	0.64l/min	3000rpm	Yes	G1/2"	G1/8"

1. Output flows are based on typical performance using 100 SUS (20 cSt) mineral oil at rated pressure.
2. Ordering codes listed are standard. Other materials and types are available upon request. For special requirements, please contact us.

Dimensions

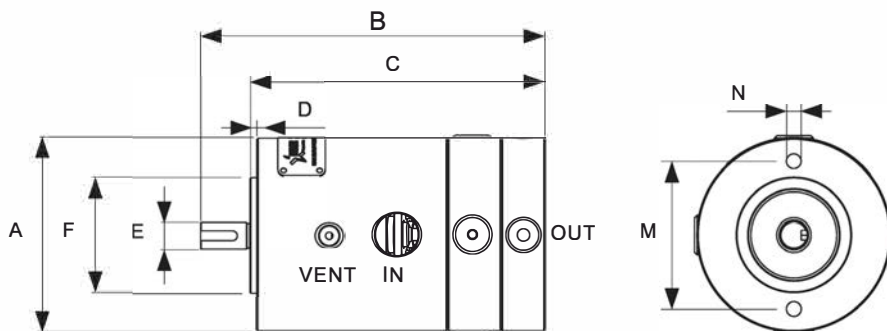

Size A	3.11 in.(79 mm)	Size E	0.43 in.(11 mm)
Size B	5.56 in.(141.3 mm)	Size F	1.85 in.(47 mm)
Size C	4.77 in.(121.1 mm)	Size M	2.56 in.(65 mm)
Size D	0.11 in.(2.8 mm)	Size N	M8

4 Inch Body Pumps

Features

- ★ Choice of 0.64 l/min, 1.02 l/min, 1.4 l/min and 2.1 l/min 4 ratios.
- ★ High-strength alloy steel pump body, and stainless steel shell optional.
- ★ Standard Buna N seals for -29~120°C service, other seals available.
- ★ Output pressures up to 15000 psi (1034 bar).
- ★ Pump can rotate clockwise and counterclockwise.
- ★ Large Flow, and very low noise.

Description

The pump is a plunger pump, it needs to be driven by a motor and recommend using electric motor. These pumps can be used on wellhead control panel systems, Power packs on high-torque service tools. The pump application medium is hydraulic oil and it needs to be installed at a lower position than the tank. Before starting the pump, you must vent the air in the pump chamber.



Performance and Specification

Ordering Code	Rated Press. psi(bar)	Max. Intermittent Press. psi(bar)	Flow at 1500rpm	Max. Speed	Stainless Steel Shell	Inlet Port	Outlet Port
ELP-4A03N	10000(690)	15000(1034)	0.64l/min	3000rpm	No	1/2"NPT	1/4"NPT
ELP-4A04N	10000(690)	15000(1034)	1.02l/min	3000rpm	No	1/2"NPT	1/4"NPT
ELP-4A05N	10000(690)	15000(1034)	1.4l/min	3000rpm	No	1/2"NPT	1/4"NPT
ELP-4A06N	10000(690)	15000(1034)	2.1l/min	3000rpm	No	1/2"NPT	1/4"NPT
ELP-4B03N	10000(690)	15000(1034)	0.64l/min	3000rpm	Yes	1/2"NPT	1/4"NPT
ELP-4B04N	10000(690)	15000(1034)	1.02l/min	3000rpm	Yes	1/2"NPT	1/4"NPT
ELP-4B05N	10000(690)	15000(1034)	1.4l/min	3000rpm	Yes	1/2"NPT	1/4"NPT
ELP-4B06N	10000(690)	15000(1034)	2.1l/min	3000rpm	Yes	1/2"NPT	1/4"NPT
ELP-4A03G	10000(690)	15000(1034)	0.64l/min	3000rpm	No	G1/2"	G1/4"
ELP-4A04G	10000(690)	15000(1034)	1.02l/min	3000rpm	No	G1/2"	G1/4"
ELP-4A05G	10000(690)	15000(1034)	1.4l/min	3000rpm	No	G1/2"	G1/4"
ELP-4A06G	10000(690)	15000(1034)	2.1l/min	3000rpm	No	G1/2"	G1/4"
ELP-4B03G	10000(690)	15000(1034)	0.64l/min	3000rpm	Yes	G1/2"	G1/4"
ELP-4B04G	10000(690)	15000(1034)	1.02l/min	3000rpm	Yes	G1/2"	G1/4"
ELP-4B05G	10000(690)	15000(1034)	1.4l/min	3000rpm	Yes	G1/2"	G1/4"
ELP-4B06G	10000(690)	15000(1034)	2.1l/min	3000rpm	Yes	G1/2"	G1/4"
ELP-4A03M	10000(690)	15000(1034)	0.64l/min	3000rpm	No	1/2"NPT	1/4" MF
ELP-4A04M	10000(690)	15000(1034)	1.02l/min	3000rpm	No	1/2"NPT	1/4" MF
ELP-4A05M	10000(690)	15000(1034)	1.4l/min	3000rpm	No	1/2"NPT	1/4" MF
ELP-4A06M	10000(690)	15000(1034)	2.1l/min	3000rpm	No	1/2"NPT	1/4" MF
ELP-4B03M	10000(690)	15000(1034)	0.64l/min	3000rpm	Yes	1/2"NPT	1/4" MF
ELP-4B04M	10000(690)	15000(1034)	1.02l/min	3000rpm	Yes	1/2"NPT	1/4" MF
ELP-4B05M	10000(690)	15000(1034)	1.4l/min	3000rpm	Yes	1/2"NPT	1/4" MF
ELP-4B06M	10000(690)	15000(1034)	2.1l/min	3000rpm	Yes	1/2"NPT	1/4" MF

1. Output flows are based on typical performance using 100 SUS (20 cSt) mineral oil at rated pressure.
2. MF means 20000psi female medium pressure connection.
3. Ordering codes listed are standard. Other materials and types are available upon request. For special requirements, please contact us.

Dimensions

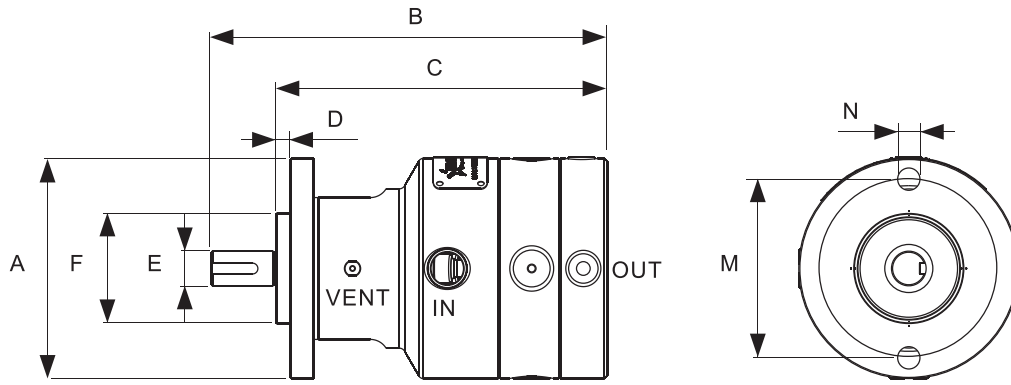

Size A	4 in.(101.6 mm)	Size E	0.63 in.(16 mm)
Size B	7.2 in.(182.9 mm)	Size F	2 in.(50.8 mm)
Size C	6.02 in.(153 mm)	Size M	3.25 in.(82.5 mm)
Size D	0.26 in.(6.5 mm)	Size N	0.41 in(10.5mm)

Repair kit

Repair kit: Contains the main seals

Repair Kit Ordering Code: **KIT-ELP-4N**

Code	Size	Code	Seal
4	4" Body Pump	N	Buna N
3	3" Body Pump	V	Viton
		K	Kalrez